

## How to log on to REMOTE DESKTOP from Home

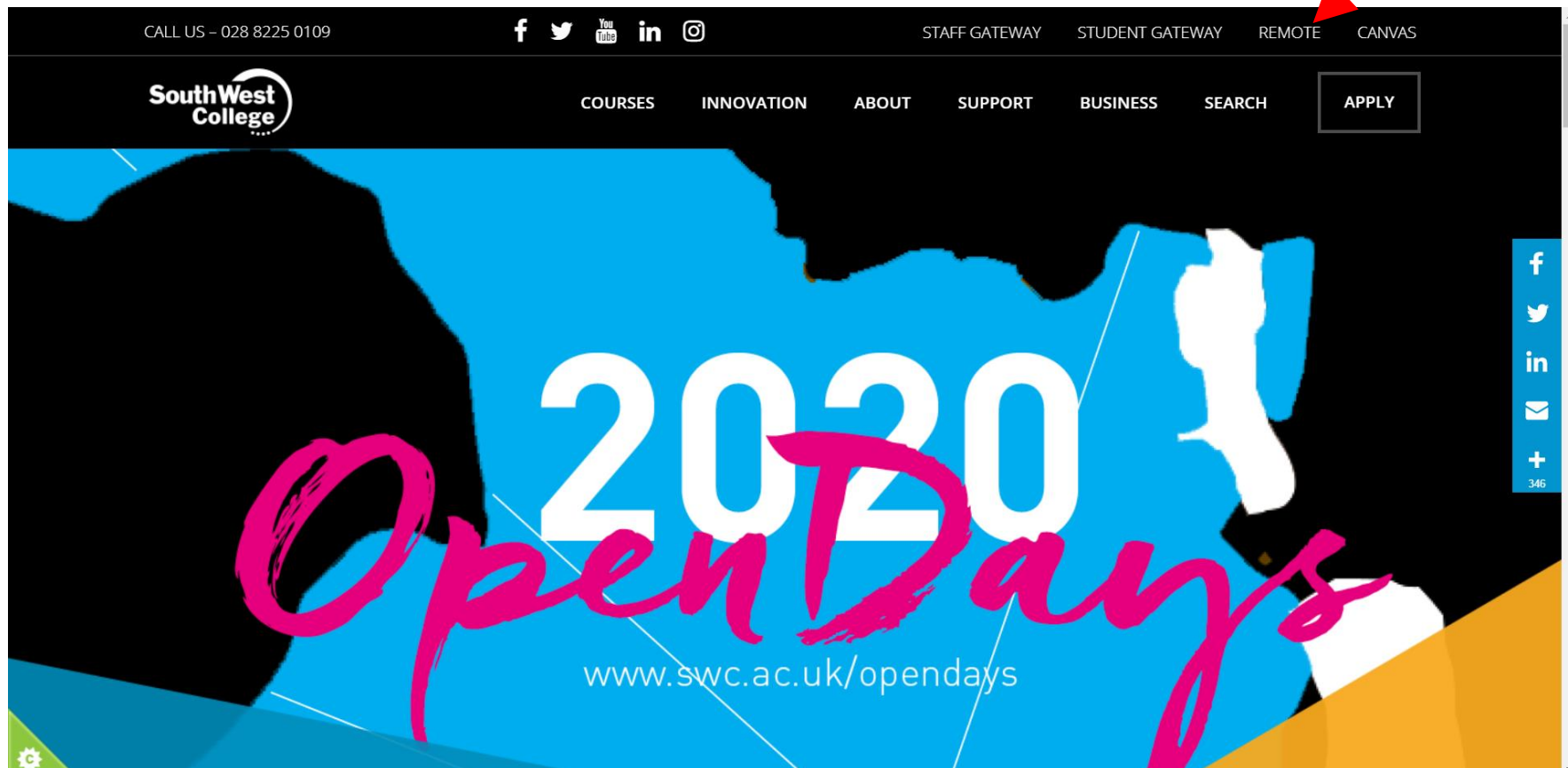

- Go to <https://www.swc.ac.uk>
- Click on **REMOTE** in the top right-hand corner

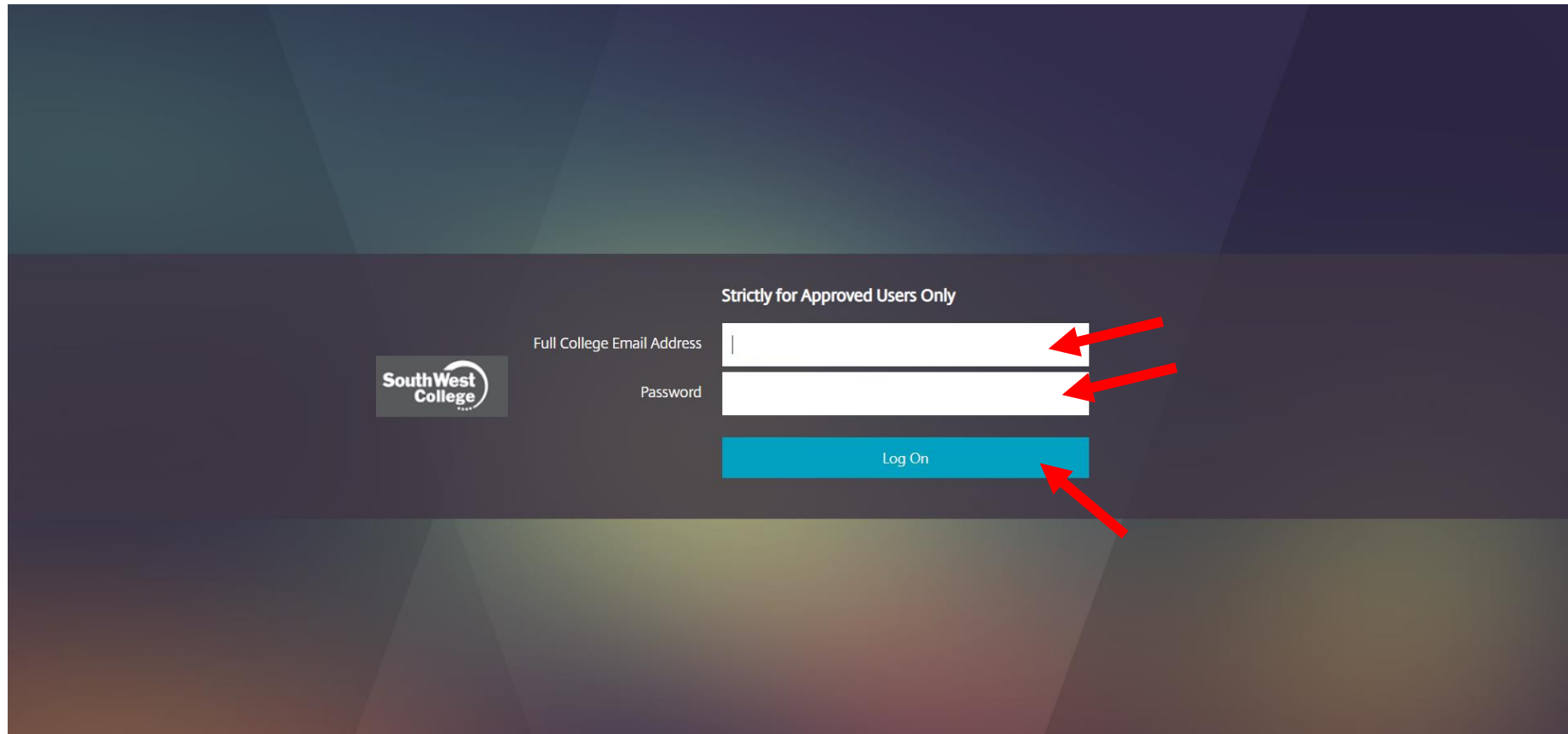

- Enter your **Full College Email Address**. You may need to type **swc\** before your email address.
- Enter your **Network Password**
- Click **Log On**

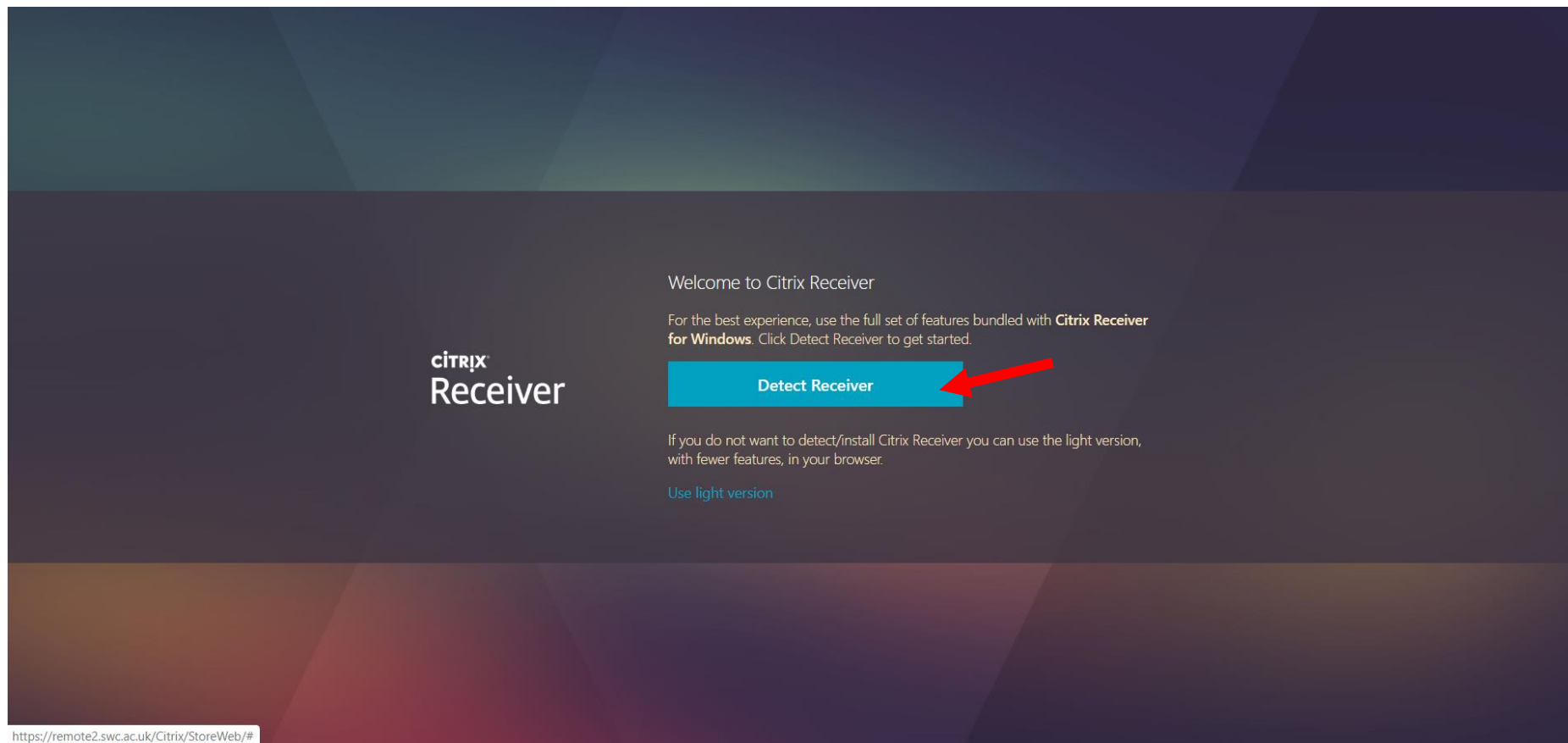

- Click **Detect Receiver**

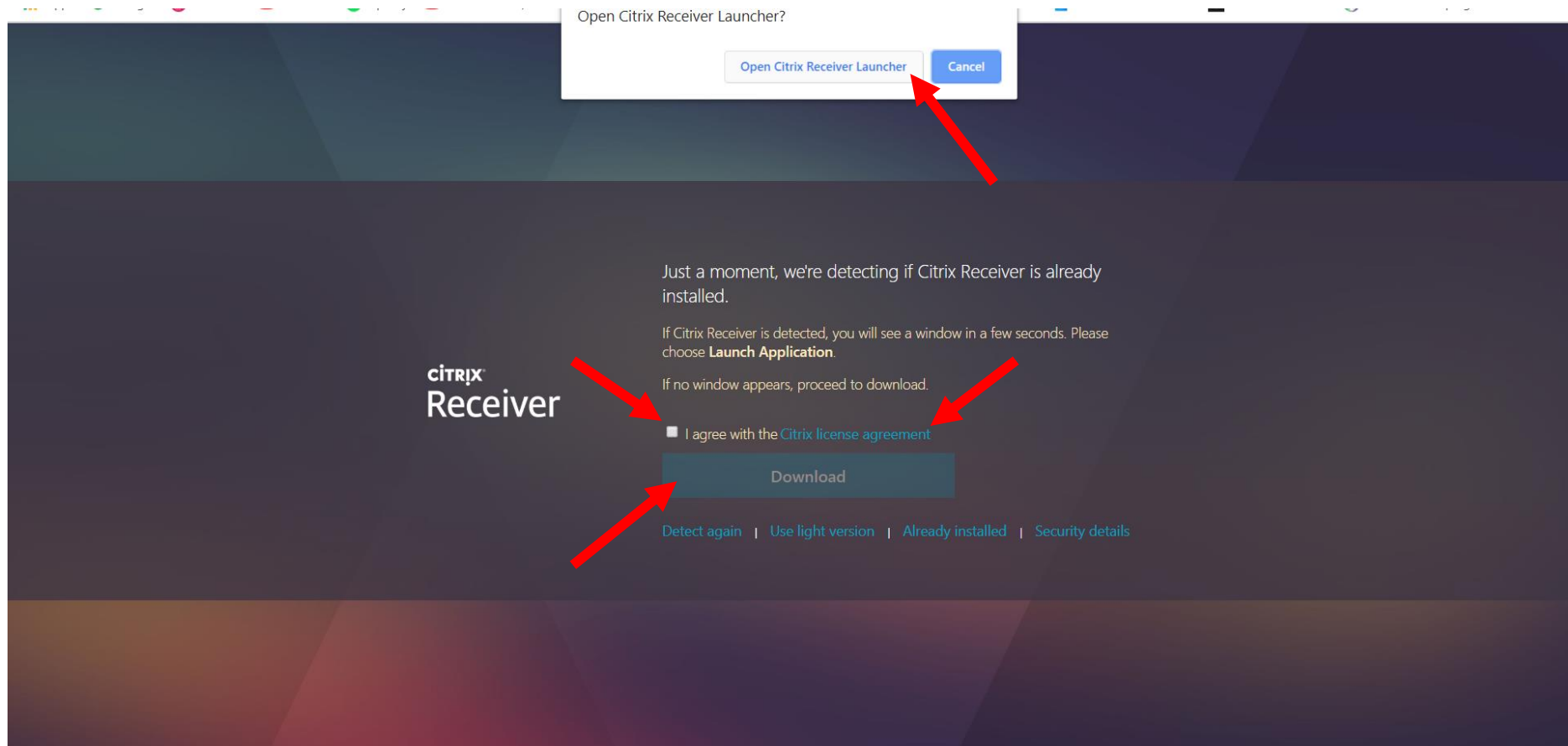

- If you have the Citrix Receiver installed you will see the message at the top - Open Citrix Receiver Launcher? Click **Open Citrix Receiver Launcher**
- If you DO NOT have the Citrix Receiver installed, READ the **Citrix License Agreement**
- Check the box beside "I agree with the Citrix license agreement"
- Click **Download**

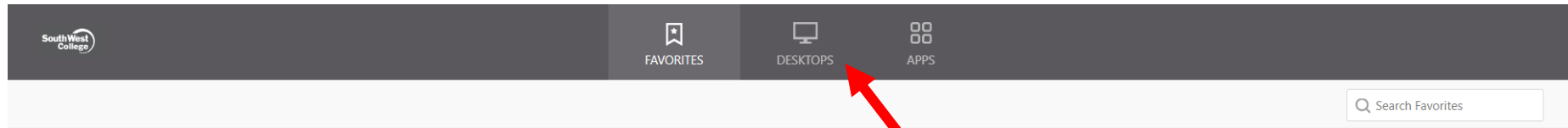

Add Favorites

Go to Desktops or Apps, click on Details next to your choice and then select Add to Favorites.

- You will now see this screen
- Click on **DESKTOPS** at the top of the page



Desktop

Details



- Click on **Desktop** at the top-left hand corner

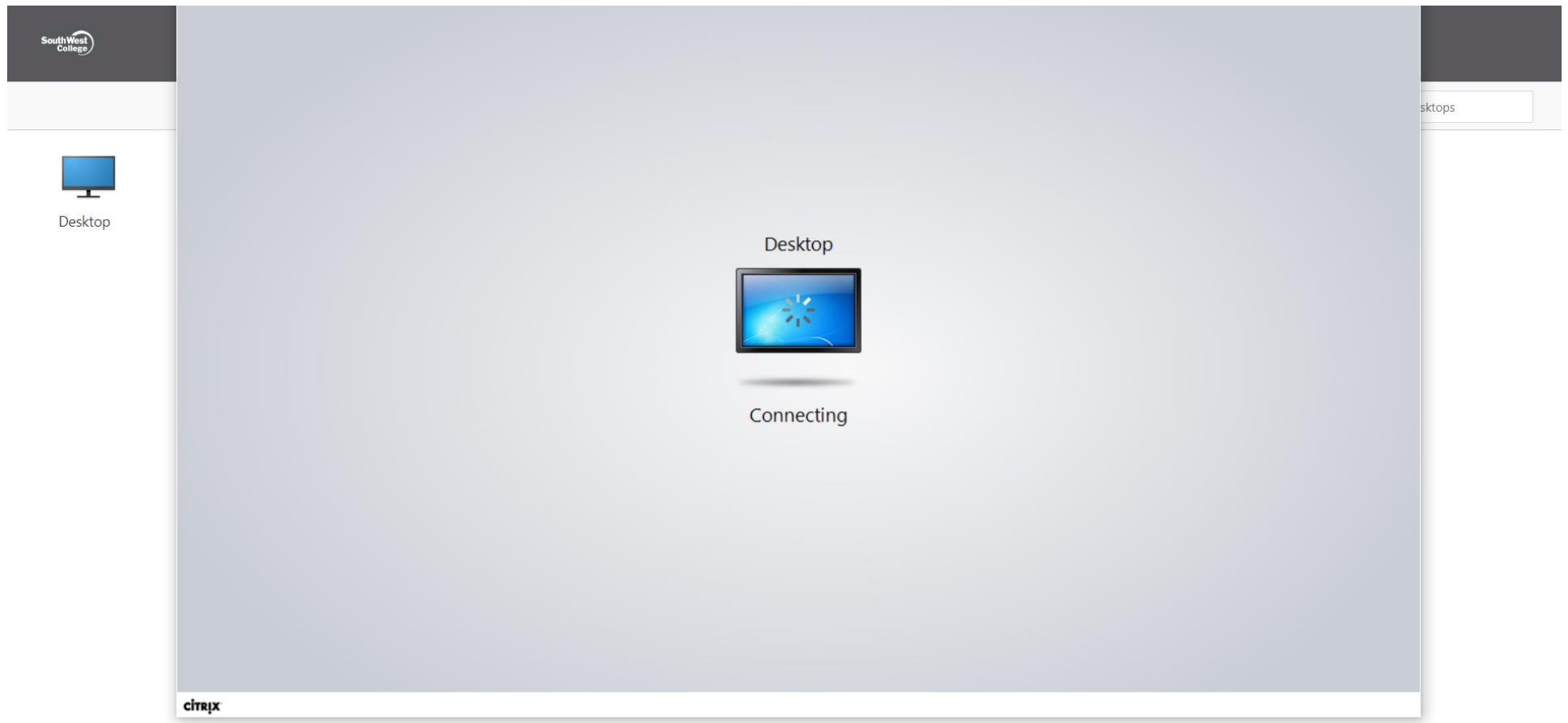

- This loading page may briefly appear while you connect to the remote desktop



- This loading page may also appear



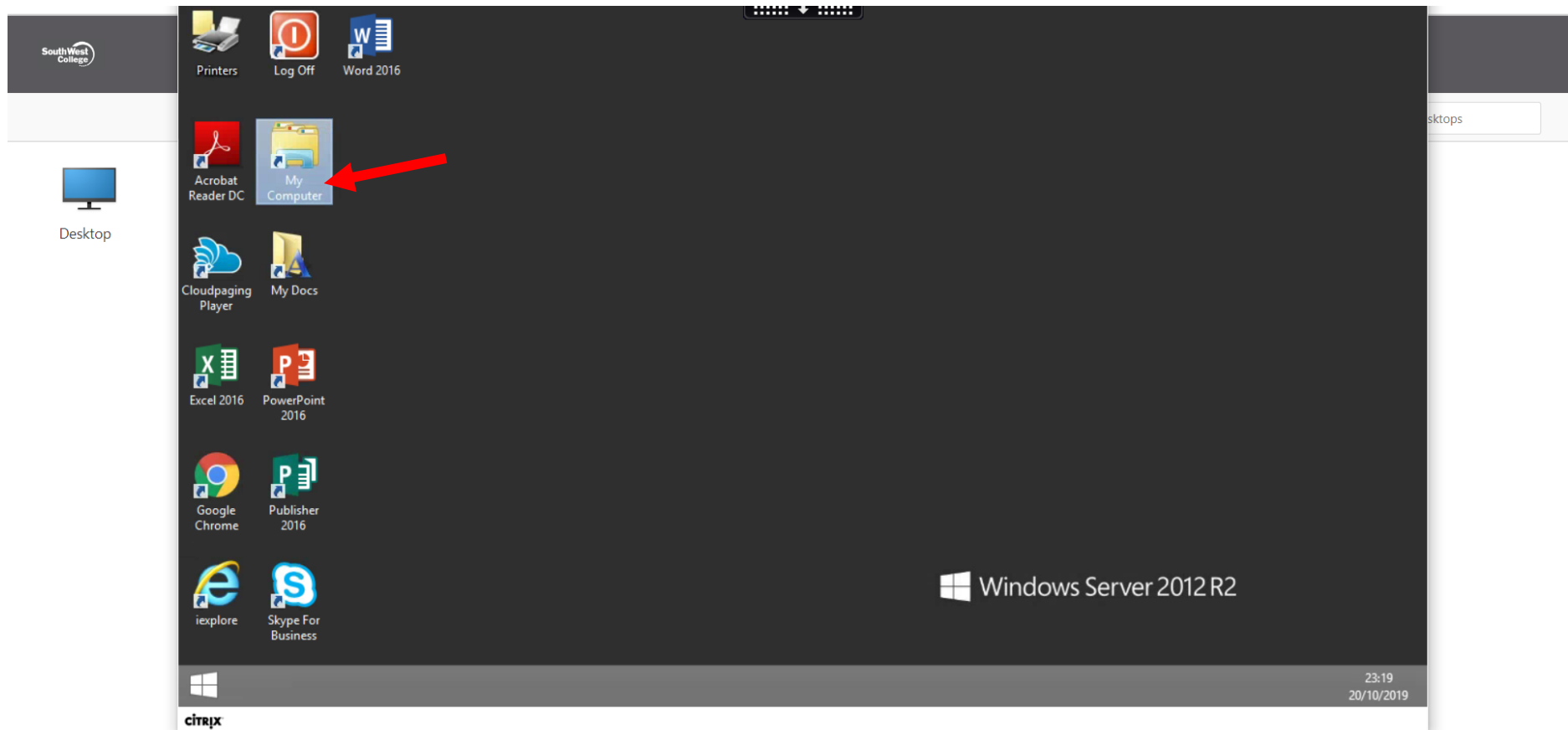

- You are now connected to the Remote Desktop
- Click on **My Computer** to access your H-Drive and network locations